

# Kama Lights®

## Installation Manual

### For Magnetic Track System

Kama elektro s.r.o.  
Říkov 97, 552 03  
Czech Republic  
IČO: 09504621 / DIČ: CZ09504621  
e-mail: info@kamaelektro.cz

Thank you for choosing our products!  
Please read this installation manual carefully before using.  
And keep it properly for future reference.

#### Please note that:

- Fixtures come with LED Drivers. Please connect the fixtures to 24V constant voltage tracks.
- Make sure power has been cut off before maintenance and installation.
- Please make sure you leave enough space of no less than 75mm around the fixtures for radiating.
- Keep a safe distance of at least 500mm between the fixtures and the objects.
- Must not violate any fire-prevention rules during using.
- Fixtures can't be installed on easily damaged or easily distorted ceiling.
- Fixtures must not be covered by insulation blanket or similar materials.
- If you have any questions regarding this installation manual, please consult with certified engineers.



**Warning**  
This series of products must NOT be directly connect to 220V Main Supply or any other power supply that is not 24V.

#### ■ 24V Power Supply Installation

This track system is 24V low voltage with maximum output of 200W(per power supply).

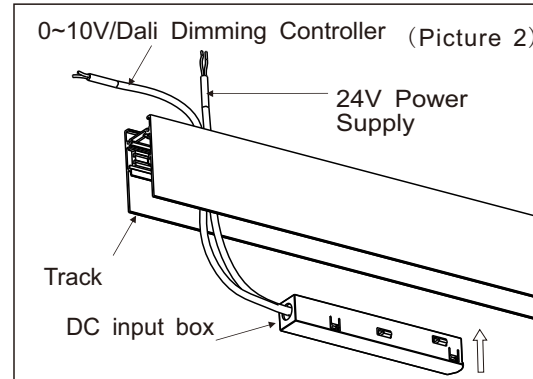
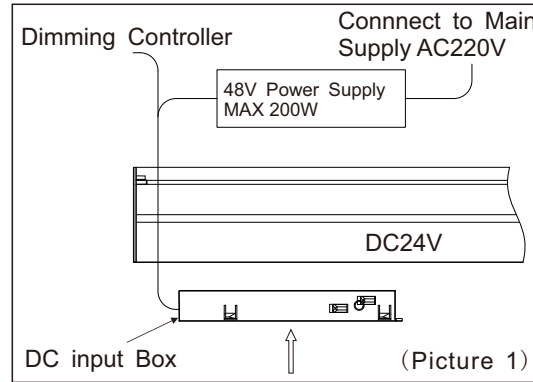

#### ■ Tracks installation

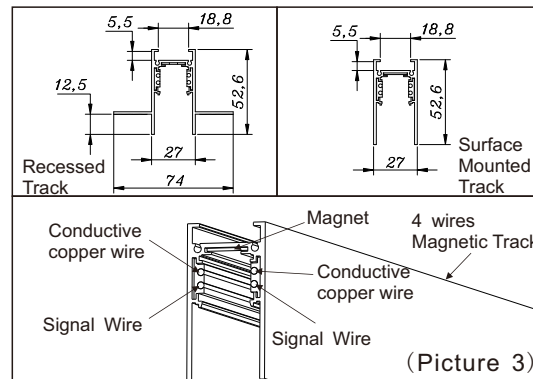

#### ■ Suspension Track Installation

1. Open the ceiling hanging kit, detach the wire locker and surface mounted holder.
2. Cut out as picture 4 shown as below (1 big and 3 small).
3. Install expansion screws into the 3 small cut out.
4. Use screws to fix the surface mounted holder and the wire locker to the ceiling.

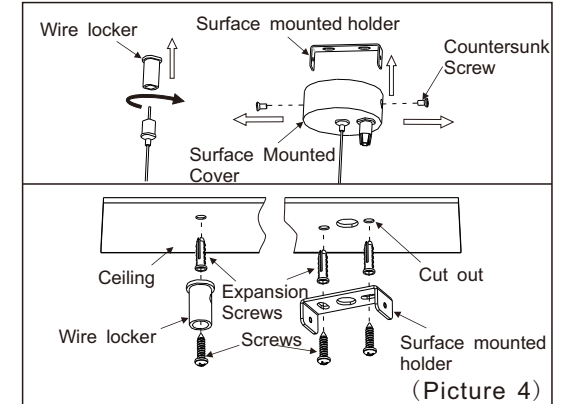

5. Install the installation plate into the track, secure it with screws. Put the DC input box's wire through the track. (As shown in Picture 5)

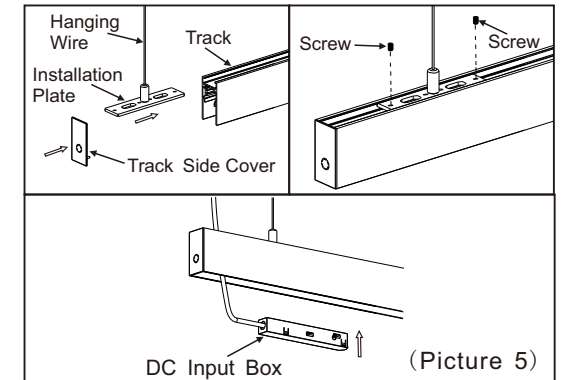

6. Connect the DC Input Box's wire to 24V power supply through the plastic wire locker in the surface mounted cover, then tighten the plastic wire locker cover.

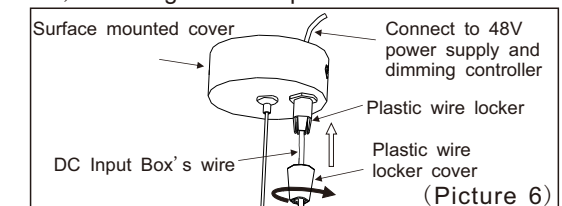

7. Fix the wire into the wire locker (as shown in the left side of Picture 5). Fix the surface mounted cover onto the holder with countersunk screws on both sides (as shown in the right side of Picture 5).

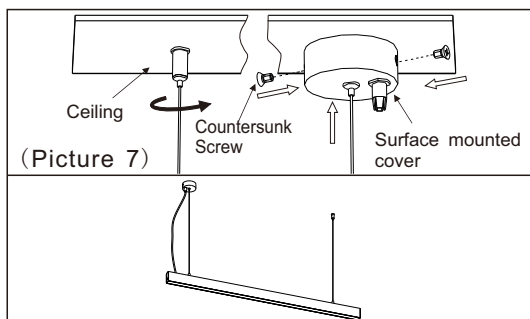

## ■ Surface Mounted Track Installation

1. Put the DC input box's wire through the track. Connect the wire to 24V Power Supply and dimming controller.
2. Drill installing holes on the ceiling according to the holes on the tracks. Put the expansion screws in the installing holes, then secure the tracks onto the ceiling with screws.
3. Install the DC Input Box into the track.

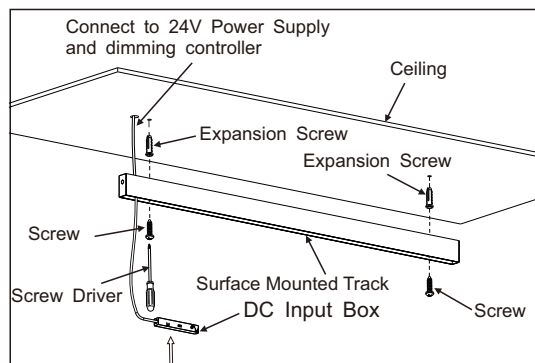

## ■ Recessed Track Installation

1. Make a cut out of 30mm's width with length slightly longer than the track in the ceiling.
2. Secure the tracks onto the ceiling through the installing holes on the wings of the tracks. (Keep the foam filling in the tracks while installing.)

3. Cover the wings of the tracks with gypsum board of 9-12mm.
4. Plastering until the surface is even. Remove the foam filling after plastering.

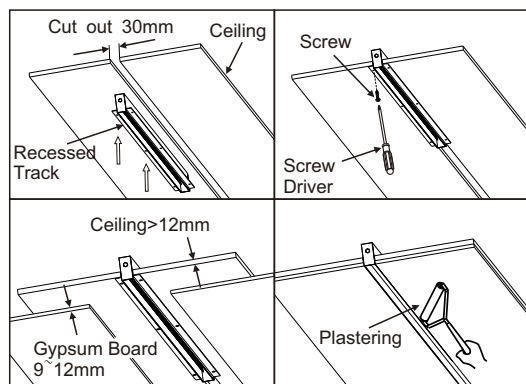

## ■ Connection of the tracks

### 1. Linear connection

- ①. Remove the side cover gently, install the connection plate between the tracks.
- ②. Tighten the screws on the two sides of the connection plate to fix the tracks together.
- ③. Install the DC conductive connector, make sure each track have one head of the connector.

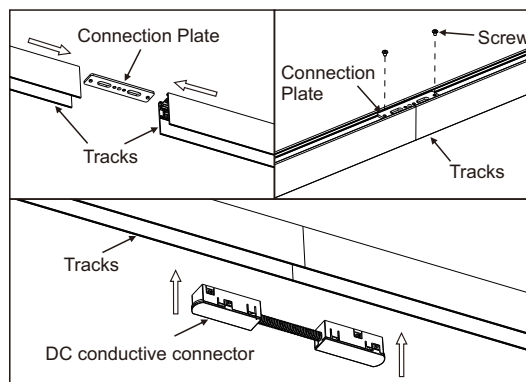

### 2. Horizontal 90° connection

- ①. Remove the side cover gently, install the horizontal connector into the tracks.

- ②. Tighten the screws on the two sides of the connection plate to fix the tracks together (two screws on each side).
- ③. Install the DC conductive connector, make sure each track have one head of the connector.

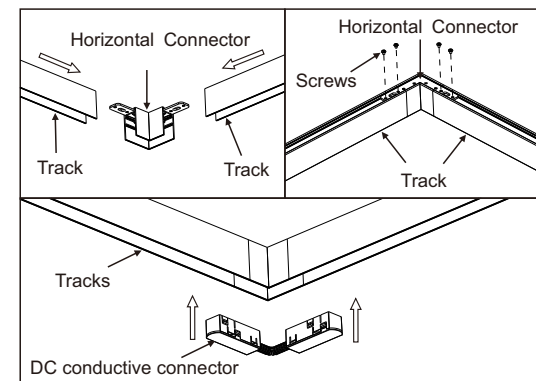

### 3. Vertical 90° connection

- ①. Remove the side cover gently, install the horizontal connector into the tracks.
- ②. Tighten the screws on the two sides of the connection plate to fix the tracks together (two screws on each side).
- ③. Install the DC conductive connector, make sure each track have one head of the connector.

